

# Matrix Keyboard



## Key Features

- > 3-joystick
- > Configuration screen
- > Network keyboard support ONVIF
- > Can control the Matrix like analog system (1 monitor +1 camera)
- > Multiple Users

## Overview

Designed to effectively manage the Matrix unit within screen division and splicing, image switching, preset set and call, keyboard lock, audio switch on/off. The keyboard also allows the Matrix to operate any IP, Onvif certified, PTZ camera through its joystick. Easily programmed buttons, user friendly, multiple users support.

## SPECIFICATIONS

Display	111x62 mm blue LCD
Communication	Network
Connection	RJ45
Key quantity	47
PTZ control	3D joystick
Operation temperature	10oC ~ 45o C
Operating voltage	12VDC
Power	5.0W
Weight	1.5 kg
Installation dimension	379x289x56mm
Installation method	Horizontal installation
Operating condition	Indoor

## DIMENSIONS

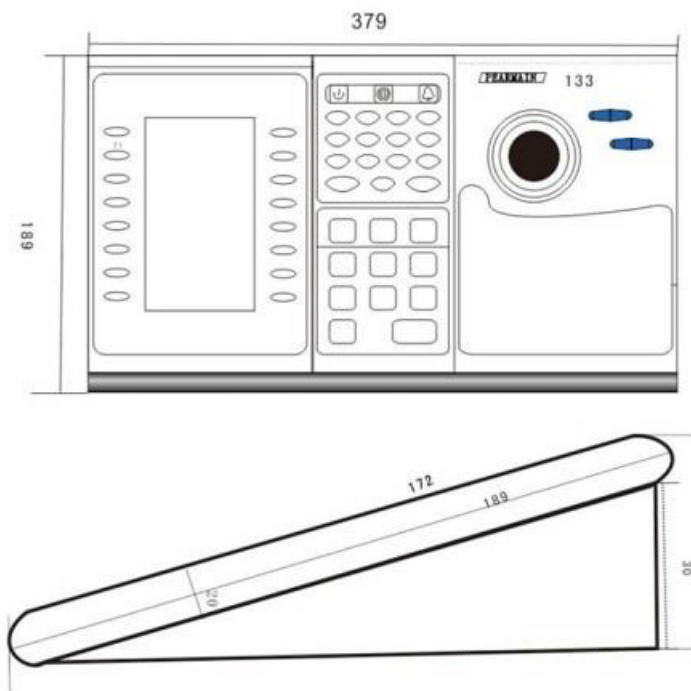

### CUBITECH LTD

R&D 12 Basepoint Business Centre, Enterprise Close, Christchurch, Dorset, Poole BH23 6NX, UK, T +44 (0) 1202 853237

DISTRIBUTION CENTER 4-6 Kiprou Str., 177 78, Tavros, Athens, Greece | T +30 210 9580887-8, F +30 210 9580885

E. info@cubitech.com | www.cubitech.com