

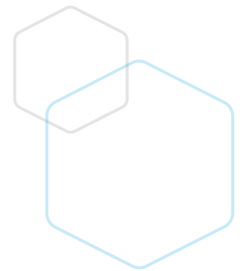

CB-DIM2028VW

1080p Dome Camera
with motorized lens



Key Features

- > 1/3" Progressive Scan CMOS
- > Motorized lens 2.7-13.5mm
- > H.265 encoding, 1080p@25fps
- > WDR (120db)
- > Smart IR Up to 30m
- > ROI, Defog, HLC, Corridor mode, DIS
- > Low bitrate, Excellent low light performance

Overview

Cubitech's middle line has been upgraded to H.265+ encoding technology, bringing high efficient video compression. With 1080p@25fps resolution and True WDR up to 120db they provide excellent image quality even in harshly backlit environments. Embedded video analytics features such as line crossing perimeter, removed object left or removed, illegal parking etc provide efficient event triggers for the most demanding security and business requirements.

SPECIFICATIONS

CAMERA

Image Sensor	1/3" Progressive Scan CMOS
Effective Pixels	1920(H)×1080(V)
Scanning System	Progressive
Electronic Shutter	1/5-1/20000s
Min. illumination	Color:0.05Lux@(F1.2,AGC ON) / B/W:0Lux@(IR LED ON)
S/N Ratio	55dB
IR Range	Up to 30m
IR On/Off Control	Auto/ Manual
IR LEDs	15pcs

LENS

Lens Type	Motorized
Iris	Fixed Iris
Focal Length	2.7~13.5mm
F Number	F1.3
Angle of View	103°~ 34.3°
Focus Control	Motorized
Close Focus Distance	0.2m

VIDEO

Compression	H.265+, H.264, MJPEG
Max. Resolution	2MP(1920×1080)
Streaming Capability	3 Streams
Stream / Frame Rate	Stream1: 1920×1080/1280×720 @25/30fps Stream2: 1920×1080/D1/ VGA/640×360/CIF/QVGA @25/30fps Stream3: VGA/CIF/QVGA @25/30fps
Day/Night	ICR
Image Enhancement	HLC / Defog / WDR (120db)
White Balance	Support
Gain Control	Auto/Manual
Noise Reduction	2D/3D DNR
Electronic Image Stabilization (EIS)	Support
Smart IR	Support
Mirror	Support
Region of Interest	Support
Motion Detection	Support
Privacy Masking	Support

AUDIO

Compression	G.711, RAW_PCM
Bit Rate	8kbps, 16kbps, 64kbps

NETWORK

Protocols	IPv4/IPv6, 802.1x, HTTP, HTTPS, TCP/IP, UDP/IP, RTSP, DHCP, NTP, RTCP/ RTP, PPPoE, SMTP, DNS, UPnP, FTP, ARP, SNMP
Interoperability	ONVIF
Streaming Method	Unicast
Max. User Access	10 Users
Web Viewer	<IE11, Chrome, Firefox
Smart Phone	IOS, Android

INTELLIGENCE

Alarm trigger	Perimeter, Single Virtual Fences, Double Virtual Fences, Loiter, Multi Loiter, Object Left, Object Removed, Abnormal Speed, Converse, Illegal Parking, Signal Bad
---------------	---

INTERFACE

Ethernet	1 Ethernet (10/100 Base-T) RJ-45 Connector
Audio I/O	1ch input, 1 ch output
Alarm I/O	1ch input, 1 ch output
RS485	N/A
BNC Output	N/A
Reset Button	Yes
Edge Storage	Micro SD, Max 128GB

ELECTRICAL

Power Supply	DC12V/PoE
Power Consumption	3W (IR LED OFF), 5W IR LED ON
Operating Temperature	Starting Temperature: -30°C ~ 50°C (-22°F ~ 122°F) Working Temperature: -30°C ~ 50°C (-22°F ~ 122°F)
Operating Humidity	Less than 90% RH
Ingress Protection	IP66, IK10
Certifications	CE / FCC
Casing	Metal
Dimensions	φ130×112mm
Net Weight	690g

DIMENSIONS

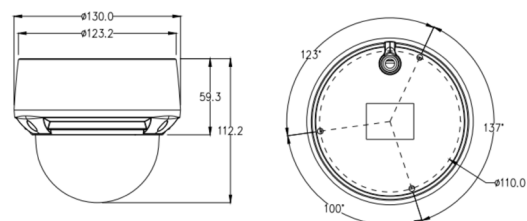

CUBITECH LTD