

# Cubis Enterprise 24 Bays

Barebone System for Advanced IP Video Management



IP ONVIF

## Key Features

- > Superior recording capability with the use of up to 24 x 16TB HDDs
- > Dual M.2 SSD disks
- > Hot swappable capabilities
- > Industrial Design
- > Maximum IP camera inputs up to 128
- > Controlled and configured locally or remotely by Cubis Software for unified user experience
- > Can be easily integrated with Cubis Software centralized monitoring platform
- > Event-driven parallel storage to Central Site

## Overview

Your ultimate partner for large scale projects. With a robust and industrial design and with extreme effectiveness to all vertical security markets, **Cubis Enterprise** is your trusted partner for an absolute worry free security installations.

## VMS Compatibility

The Cubis Enterprise 24 Bays is designed for optimized integration with all Cubis Software versions and Add-on Modules. With industry wide specifications, Cubis Software complies with the requirements of every type of a security project. With supreme upgradability and scalability, Cubis Software provides a seamless and easy delivery of its supreme capabilities.

Cubis Basic



Cubis Advanced



Cubis Modules



## SPECIFICATIONS

Total Video channels	Up to 128ch
Total Throughput	Up to 960Mbps
Lan card	Up to 5 x1 Gbit
CPU	Up to i7 or Xeon
Mem	8GB Up to 16GB
Effective Storage	Up to 334.7TB HDD (RAID 5)
Operating System Disks	2xM.2 SSD boot Raid1 & 24 Storage 3.5" (optional)*
Raid Capability	0, 1, 1E, 5, 5EE, 6, 10, 50, 60 and JBOD
USB Ports	Up to 8x
Hot swap HDD	Yes
Network Interface	10M/100M/1000M self-adaptive ethernet interface
Lan ports	3
Operating System	Windows 10 Professional* (Windows Server 2016 Standard optional)
HDMI	1
DVI-D	1
PS/2	1
VGA	Optional (depending on model)
Audio jacks	6
VMS	License Dongle and Advanced Server License
Wallmounted	No
Rackmounted	Yes
Support Failover	Yes
Rails	Yes
Redundant PSU	Yes
Power Consumption	800W
Input Voltage	220~240 AC
Size	4U
Weight	28 kgs
Dimensions (WxLxH)	437 x 550 x 176mm
Warranty	2 years, parts and labor

\* It is included

## KEY FEATURES

- > Up to 128 Channels supported
- > Dual SSD or M.2 SSD Disk preloaded (depending on model)
- > Up to 24 x 16TB HDD capacity
- > Raid HDD configuration (0, 1, 1E, 5, 5EE, 6, 10, 50, 60 and JBOD)
- > Hot Swappable storage HDD capability
- > Maximum effective storage up to 334.7TB (Raid 5)
- > Redundant Power supply
- > Rails and doors included
- > Industrial design

- > Rack mounted
- > Controlled or configured locally or remotely by Cubis Software
- > Fully integrated with all Cubis Software versions

## MODELS

MODEL	PART No.	DESCRIPTION
CBEN24B-32IP	2130020	32IP channels
	2130022	32IP channels + Xeon processor
	2130023	32IP channels + Xeon processor + Windows Server stand. 2016 + 16GB Memory
CBEN16B-64IP	2130021	64IP channels
	2130025	64IP channels + Xeon processor
	2130026	64IP channels + Xeon processor + Windows Server stand. 2016 + 16GB Memory
CBEN16B-128IP	2130024	128IP channels + Xeon processor + 16GB Memory
	2130027	128IP channels + Xeon processor + Windows Server stand. 2016 +16GB Memory

## ACCESSORIES

PART No.	MODEL
7064016	Ethernet D I/O 8ch
7016088	On Board 8ch D I/O+RS-485

## DIMENSIONS

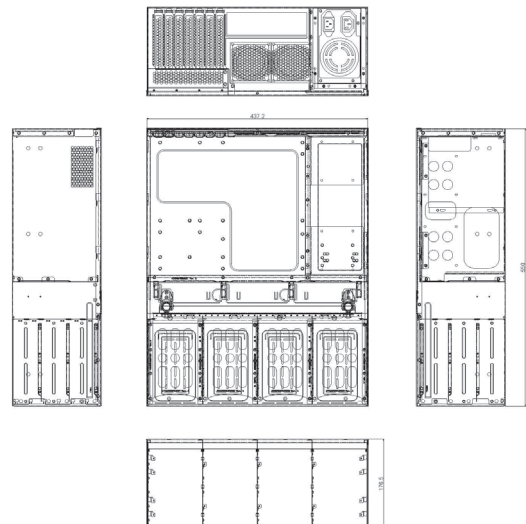

## CUBITECH LTD

R&D 12 Basepoint Business Centre, Enterprise Close, Christchurch, Dorset, Poole BH23 6NX, UK, T +44 (0) 1202 853237

DISTRIBUTION CENTER 4-6 Kiprou Str., 177 78, Tavros, Athens, Greece | T +30 210 9580887-8, F +30 210 9580885

E. info@cubitech.com | www.cubitech.com